

PARTS LIST						
ITEM	QTY	PART NO.	PART DESCRIPTION	LENGTH	UNIT WT.	NET WT.
1	2	X-CSRT-GP30D	3" DOUBLE GUSSET PLATE	24 in	4.88	9.76
2	6	G1205	1/2" x 5" HDG HEX BOLT GR5 FULL THREAD	5 in	0.33	1.96
3	12	G12FW	1/2" HDG USS FLATWASHER	3/32 in	0.03	0.41
4	6	G12LW	1/2" HDG LOCKWASHER	1/8 in	0.01	0.08
5	6	G12NUT	1/2" HDG HEAVY 2H HEX NUT		0.07	0.43
					TOTAL WT. #	12.64

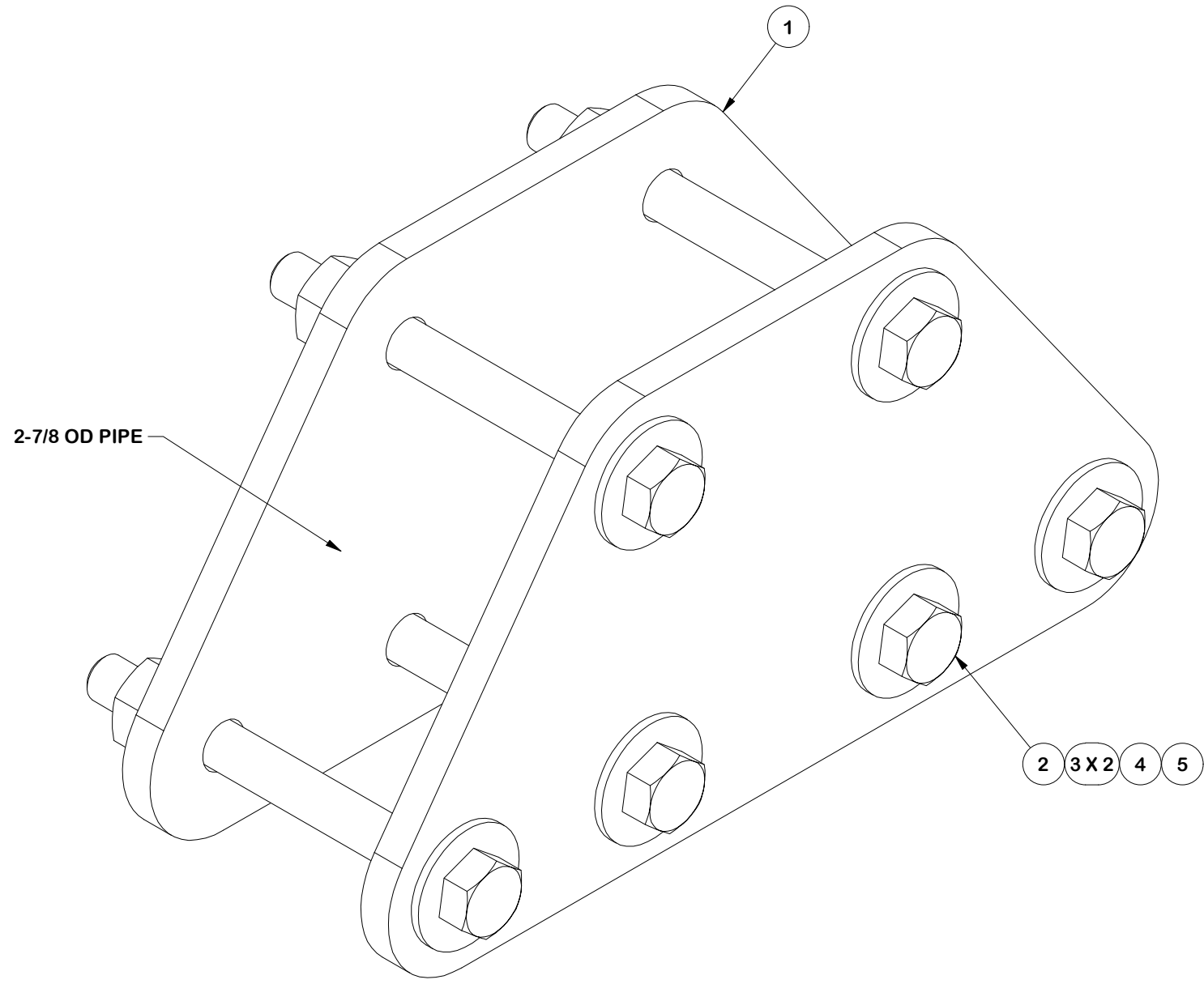

FINISH:
HOT DIP GALVANIZED.

TOLERANCE NOTES

TOLERANCES ON DIMENSIONS, UNLESS OTHERWISE NOTED ARE:
 SAWED, SHEARED AND GAS CUT EDGES ($\pm 0.030"$)
 DRILLED AND GAS CUT HOLES ($\pm 0.030"$) - NO CONING OF HOLES
 LASER CUT EDGES AND HOLES ($\pm 0.010"$) - NO CONING OF HOLES
 BENDS AND ANGLES ARE $\pm 1/2$ DEGREE
 ALL OTHER MACHINING ($\pm 0.030"$)
 ALL OTHER ASSEMBLY ($\pm 0.060"$)

PATENT INFORMATION: WWW.SITEPRO1.COM/PATENTS

PROPRIETARY NOTE:
 THE DATA AND TECHNIQUES CONTAINED IN THIS DRAWING ARE PROPRIETARY INFORMATION OF VALMONT INDUSTRIES AND CONSIDERED A TRADE SECRET. ANY USE OR DISCLOSURE WITHOUT THE CONSENT OF VALMONT INDUSTRIES IS STRICTLY PROHIBITED.

DESCRIPTION
CSRT DUAL GUSSET PLATE KIT

CPD NO. NCS	DRAWN BY ADB 12/2/2024	ENG. APPROVAL 12/2/2024
CLASS 87	SUB 02	DRAWING USAGE CUSTOMER
CHECKED BY CSL 12/2/2024		

SITE PRO 1
 A valmont COMPANY

Engineering Support Team:
 sp1engineering@valmont.com

PART NO. CSRT-GP30D	PAGE 1 OF 1
DWG. NO. CSRT-GP30D	